

MODEL RLR314A

LABORATORY REFRIGERATOR

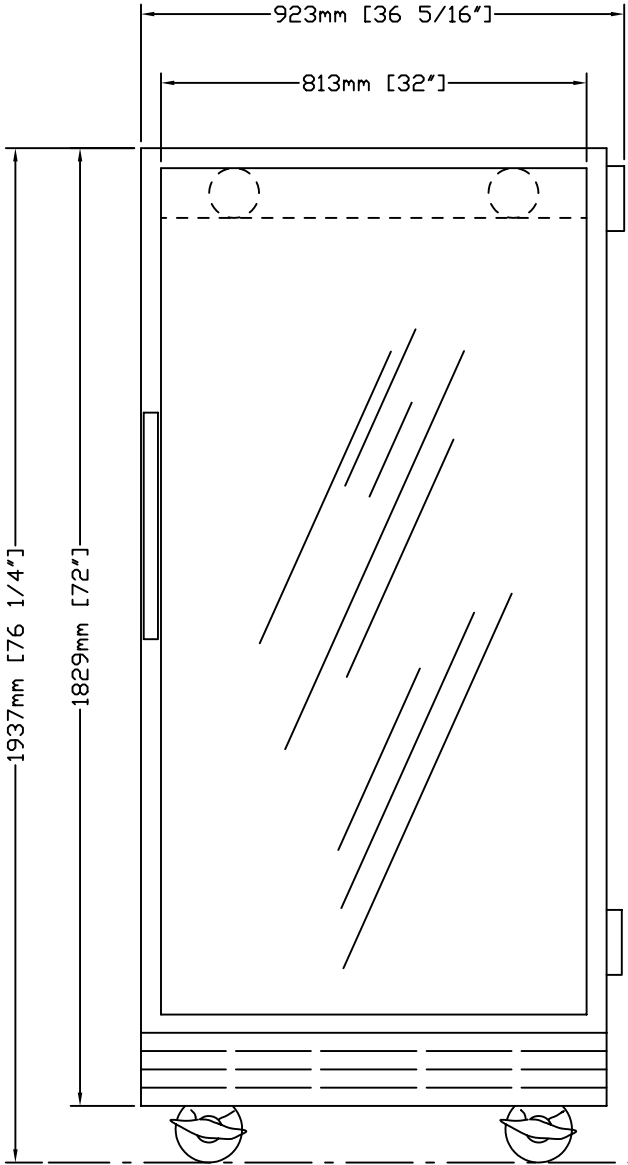

FRONT VIEW

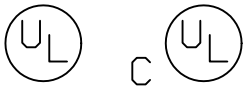
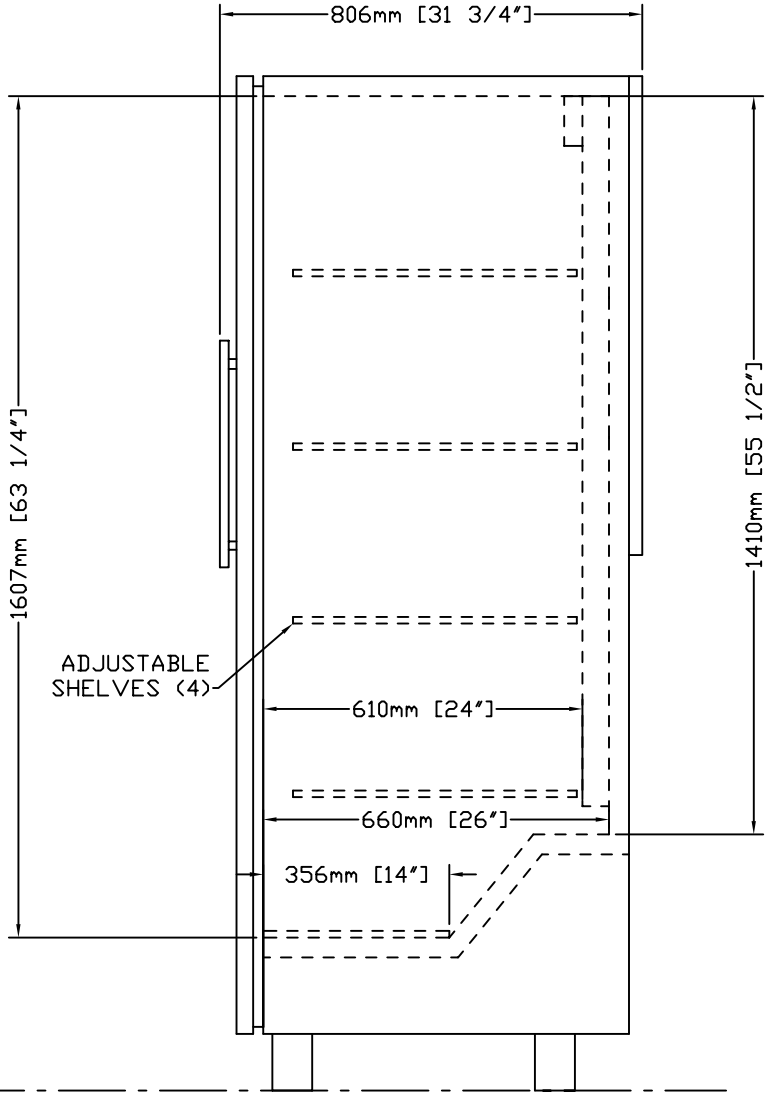

SIDE VIEW

11/2003

REVCO
 275 Aiken Road
 Asheville, NC 28804
 TEL. 1-800-252-7100
 TEL. 828-658-2711 FAX 828-658-0363

MODEL RLR314A

GENERAL SPECIFICATIONS

EXTERIOR - WHITE TEXTURED VINYL ON STEEL

WIDTH 923mm (36.3") DEPTH 806mm (31.8") HEIGHT 1937mm (76.3")

INTERIOR - WHITE TEXTURED VINYL ON STEEL

WIDTH 813mm (32") DEPTH 610mm (24") HEIGHT 1607mm (63.2")

INSULATION - FOAMED-IN-PLACE POLYURETHANE

GASKET - MAGNETIC

DOOR - GLASS, NO LOCK

SHELVES - (4) EPOXY, ADJUSTABLE IN 51mm (2") INCREMENTS

CASTERS - (4) WITH BRAKES

CONTROL - (1) THERMOSTATIC, MAY BE SET FOR DESIRED TEMPERATURE

+2°C TO +10°C (36°F TO 50°F), FACTORY SET TO +4°C (39°F)

DEFROST - AUTOMATIC

COMPRESSOR - 1/3 H.P., R134a REFRIGERANT, NOMINAL BTU'S TO ROOM

AMBIENT - 334 WATTS (1138 BTU'S/HR)

DECIBEL RATING - 45 dBA

CAPACITY - 881 L (31.1 CU. FT.)

ELECTRICAL DATA - 120/60/1 7.2 AMPS

SHIPPING WEIGHT - 159 KG (350 LBS)

SHIPPING VOLUME - 2.4 CU. METERS (86 CU. FEET)